

## PPS GSQ - SQ Profile grey

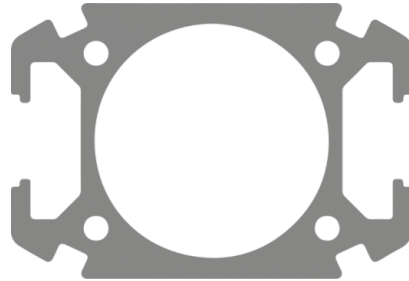

<b><u>Pipe ID (in)</u></b> 1"	<b><u>Length (ft)</u></b> 3.28	<b><u>Technology</u></b> PPS Grip Concept	<b><u>Operating pressure</u></b> 0 to 232 psi
<b><u>Vacuum capability</u></b> -29 inHg (vacuum 98%)	<b><u>Temperature</u></b> -4°F to +176°F	<b><u>Construction</u></b> Pipe and fittings: aluminum	<b><u>Highlight</u></b> Scalable system
<b><u>Meets standards</u></b> ASME B31.3 REACH			

Beschreibung		
Artikelnummer	Rohrinnen-Ø (mm)	Länge (m)
PPS GSQ2510	25	1
PPS GSQ2520	25	2

